

Please read the instructions carefully before commencing installation.

WARNING !

1. Must be installed by a licensed electrician in accordance with S/NZS 3000:2007 Amendment 2:2012 Electrical Installation
2. Switch off power supply before installation.
3. Switch on only after complete installation and examination of the circuit.

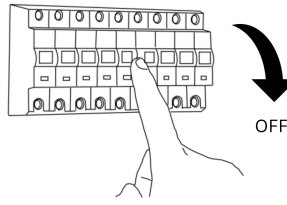

Important Safety Instructions

When installing or using this track system, basic safety precautions should always be followed, including the following:

1. Read all instructions carefully before commencing installation.
2. For indoor ceiling installation only. Do not install the product in any other locations. Do not install this track in damp or wet locations.
3. Do not install any part of a track system less than 1.5 meter above the floor.
4. Do not install any luminaire assembly closer than 30 cm from any curtain or similar combustible material.
5. Turn off power before installation or before doing any maintenance work.
6. Do not exceed the normal supply voltage or amperage ratings.
7. Do not attempt to energise anything other than lighting track luminaires on the track. To reduce the risk of fire and electric shock, do not attempt to connect power tools, extension cords, appliances to the track.
8. Product must be mounted in location and at height in a manner consistent with its intended use.

ADAPT GU10 TRACK LIGHT INSTALLATION INSTRUCTIONS

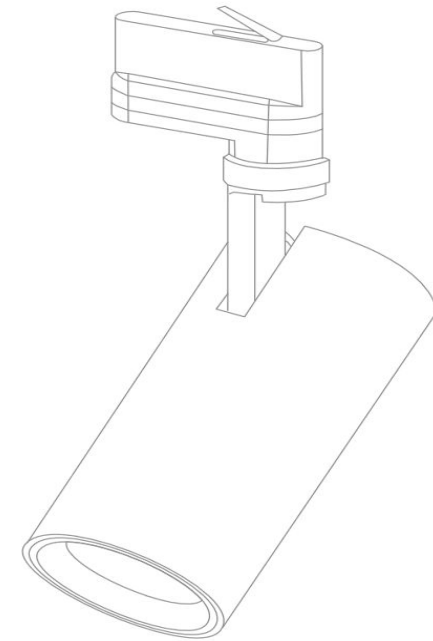

Installation for GU10 Track Light

1

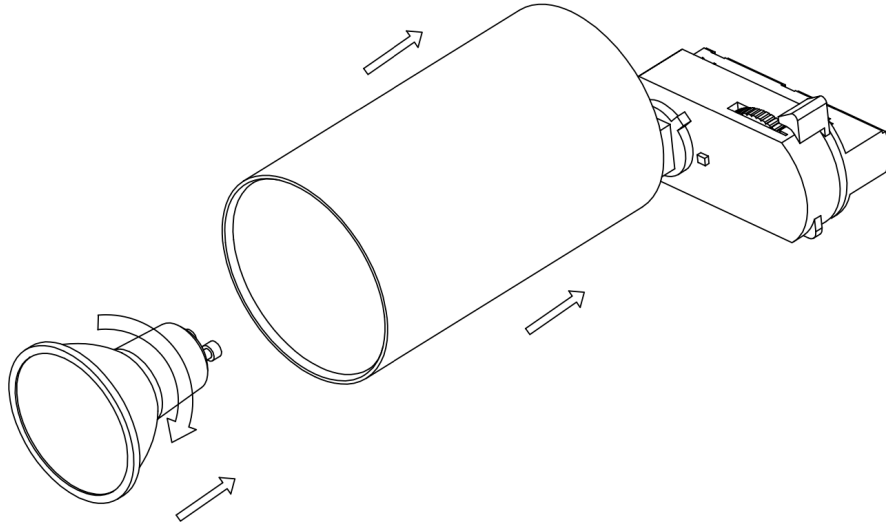

2

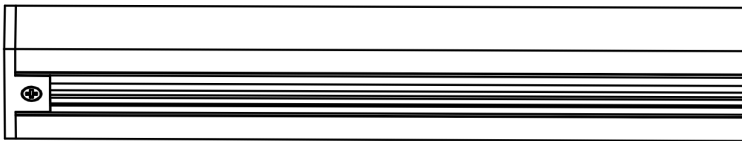

The polarity is the a shallow groove on the surface of the track.

3

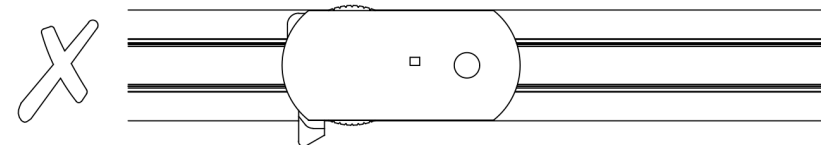
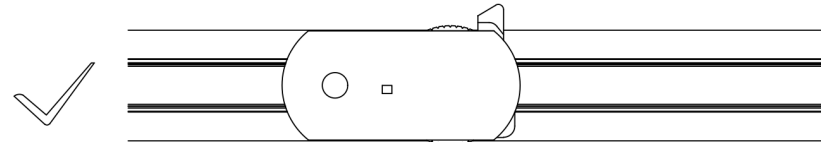
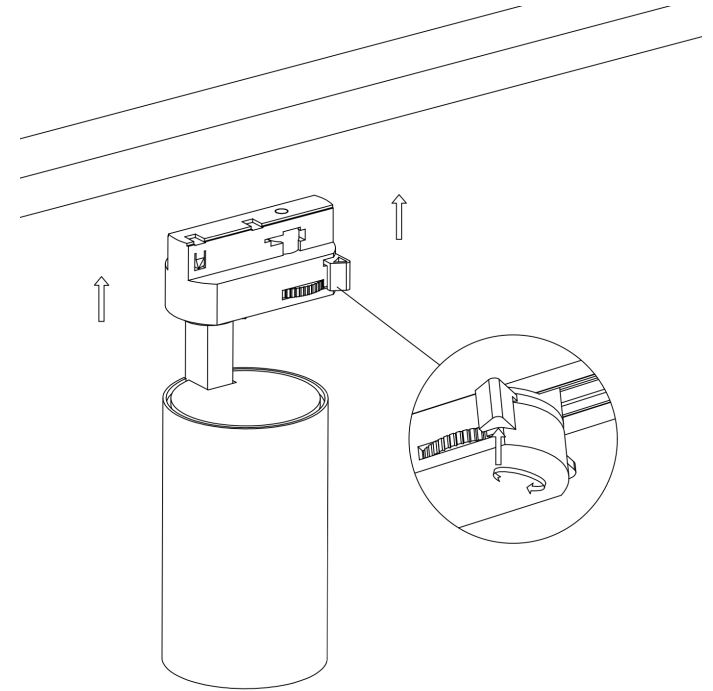

4

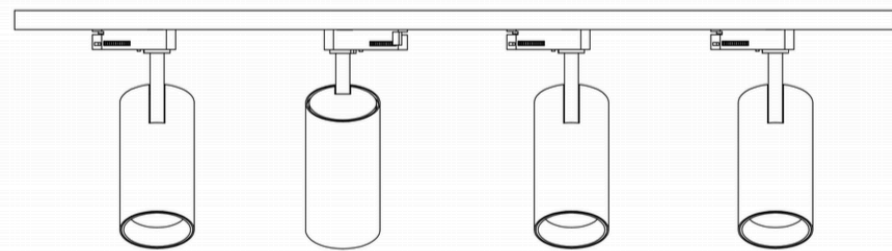
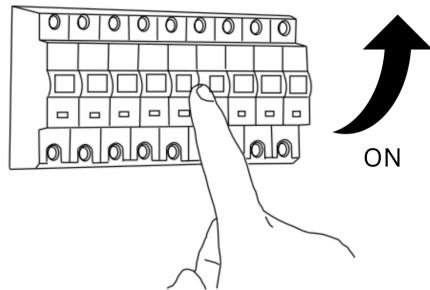
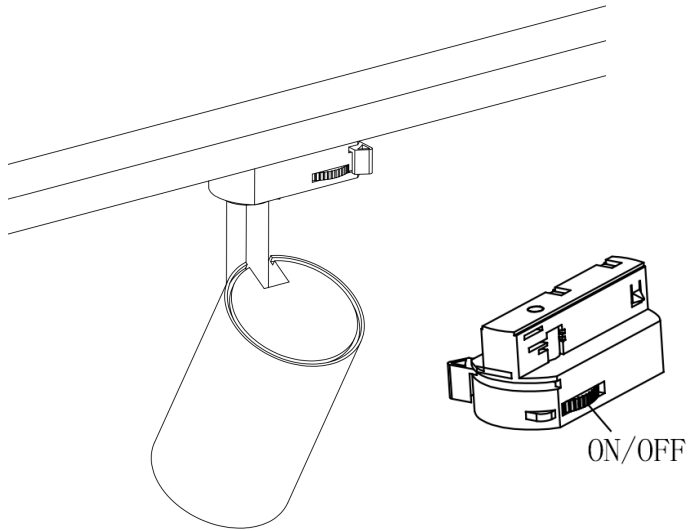

Track Installation

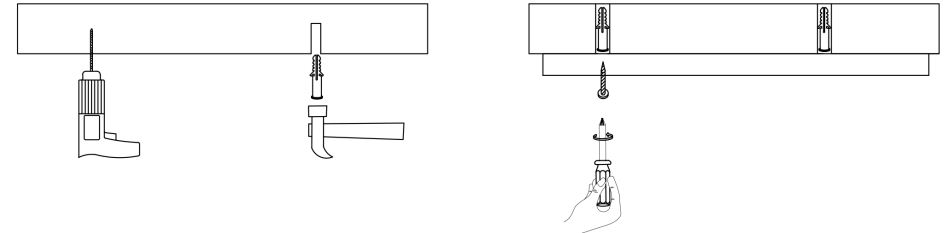

Wiring Diagram

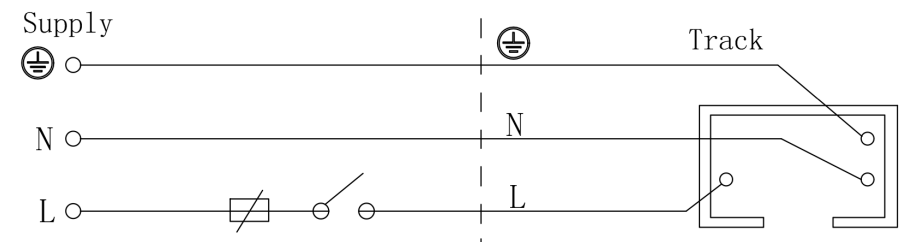

1-phase, 1-circuit, 230V AC, 10A, 3kVA

Product Specification

Product Code	210045	210046
Configuration	3 Wire Single Circuit	
Material	Aluminium + PC	
Finish	Matt White	Matt Black
Wattage	Max. 10W	Max. 10W
Light Source	GU10 LED Globe Max. 10W (Not Included)	
Beam Angle	Lamp Dependent	
Colour Temperature	Lamp Dependent	
Luminous Flux	Lamp Dependent	
CRI	Lamp Dependent	
Dimmable	Yes - Triac Dimming	
Tilt Adjustable Angle	90° Vertical 350° Horizontal	
Protection Class	Class 1	
IP Rating	IP20	
Input Voltage	AC 220-250V 50Hz	
Dimension	Φ62x H105mm	

- Dimming compatibility - It is the installer's responsibility to validate dimming circuits and product compatibility prior to installation. Alacio is not liable for any third-party changes affecting dimmer compatibility.

www.alacio.com.au

Product Warranty

This product is covered by a 3 year replacement warranty. Contact your place or purchase for a replacement in the unlikely event of product failure within the warranty period.

Warranty void if safety instructions and and installation procedures are not followed or if the product has been modified.

Care and Maintenance

Always be certain that electric current is turned off before cleaning this item

Use a soft, moist cloth with mild non-abrasive soap to clean fixture. Never use glass cleaner on fixture, as it will damage the metal finish.

Disposal

This product must not be disposed of with the household refuse at the end of its life cycle. Take it to your local disposal centre for electrical and electronic waste.



Product design and technical data may be subject to change